

## W-Series



The MarinePod® W-Series is a range of housings designed to complement the latest advancements in widescreen chart plotter design, technology and aesthetics. Three models are available to house small to medium sized plotters on to either 9½” or 12” centre-to-centre binnacle rails or on to any flat surface by way of the swivel deck mount.

Housing to allow the easy installation of small widescreen plotters up to 7" screen size.



**W7**  
Pod only

**W7-H**  
Helm mount

**W7-DW**  
White deck base

**W7-DB**  
Black deck base

## Product Order Codes

# Pod Dimensions

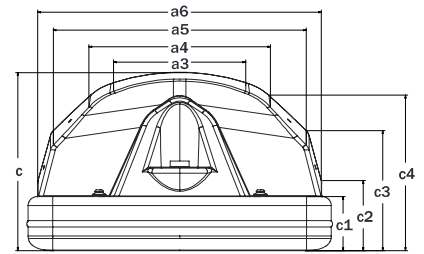
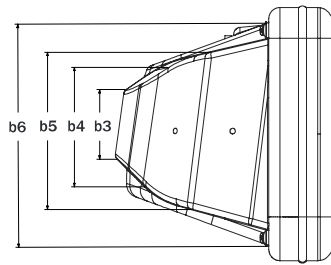
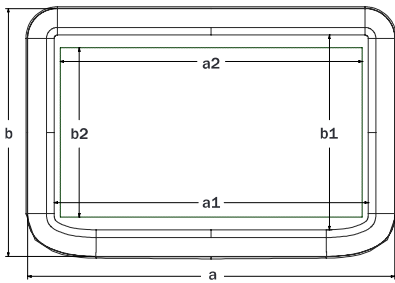

Pod Face Dimensions											
External Dimensions			Max Useable Face				Max Cut Out Area				
a	b	c	a1	b1	a2	b2					
271	183	160	233	145	223	128					
Pod Back Dimensions											
Width				Height				Depth			
a3	a4	a5	a6	b3	b4	b5	b6	c1	c2	c3	c4
118	160	232	254	44	77	113	138	47	62	105	139

## As Installed Pod Dimensions

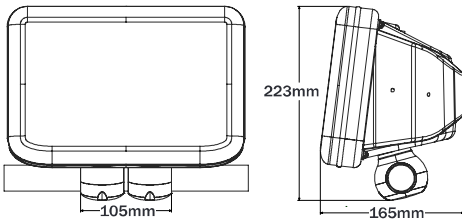

### Horizontal Rail

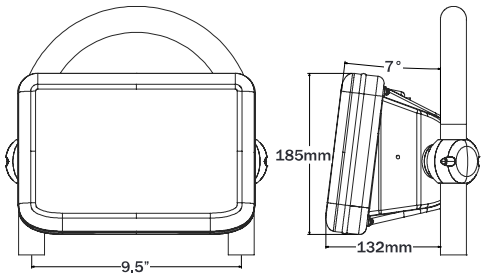

### 9.5" Binnacle Rail

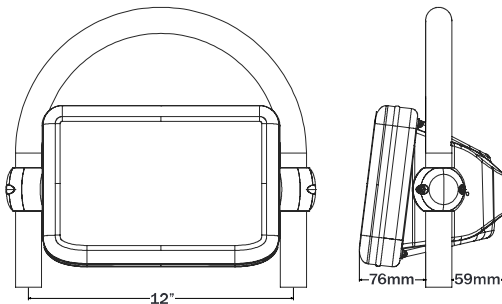

### 12" Binnacle Rail

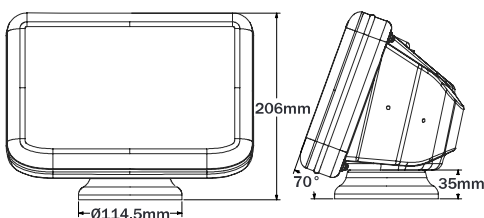

### Deck Mount

## Pod Plotter Compatibility

Brand	Model Number
B&G	H3000 FFD H3000 GFD/GPD 20/20HV
Furuno	Navpilot 700 GP33/37 SC50/110 GPI870/F
Garmin	GPSMAP620 GPSMAP451/S/551/S/556/S GPSMAP750/S/721/751
Lowrance	HDS-5/5x/5m/5m Gen2 Elite-7m
NASA Marine	Target Navtex Pro Plus V2
Nexus	XL30 NX2 MultiXL/XL20 Multi Control
Raymarine	a75/77/78 e7/D A50/D
Seiwa	FT70 SW501i/501e
Techmarine	S50.02 - S55.02
Standard Horizon	CP/F 190i/F/390i
Vesper Marine	AIS watchmate 650/750/850 Watchmate Vision



Housing to allow the easy installation of small/medium widescreen plotters up to 9" screen size.



**W9**  
Pod only

**W9-H**  
Helm mount

**W9-DW**  
White deck base

**W9-DB**  
Black deck base

## Product Order Codes

# Pod Dimensions

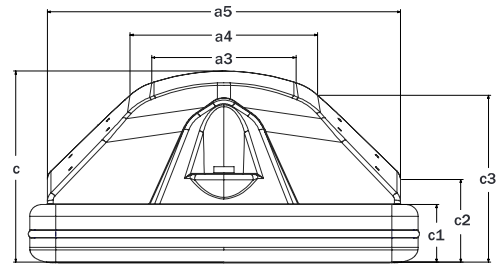
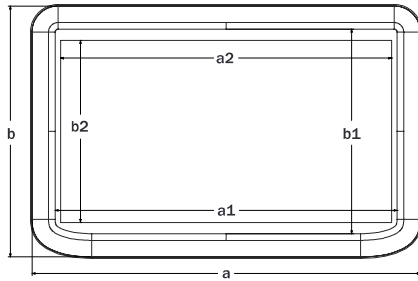

Pod Face Dimensions											
External Dimensions			Max Useable Face				Max Cut Out Area				
a	b	c	a1	b1	a2	b2					
328	212	160	290	174	280	158					
Pod Back Dimensions											
Width			Height				Depth				
a3	a4	a5	b3	b4	b5	b6	c1	c2	c3		
122	161	299	79	113	137	192	48	69	141		

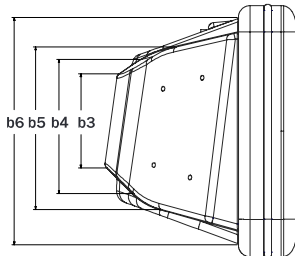

## As Installed Pod Dimensions

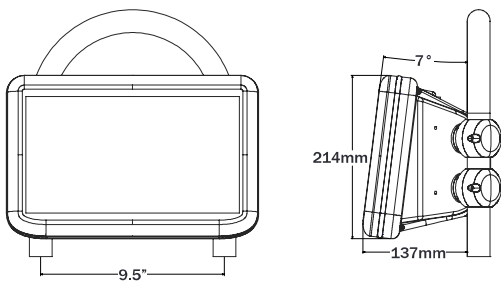

**9.5" Binnacle Rail**

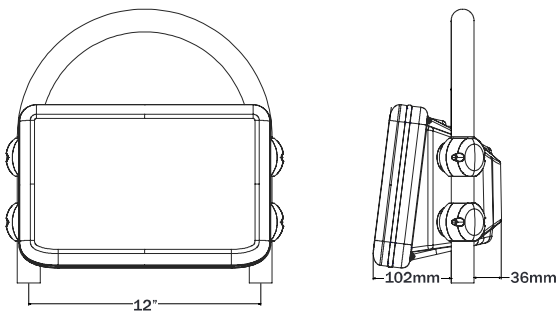

**12" Binnacle Rail**

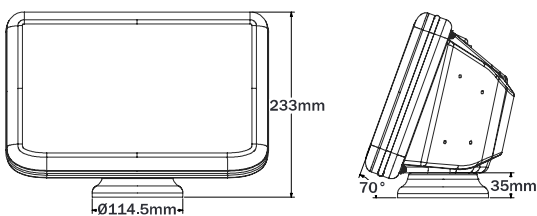

**Deck Mount**

## Pod Plotter Compatibility

Brand	Model Number
B&G	30/30HV Zeus Touch 7
Furuno	FCV-627/GP-1670/F
Humminbird	800/900 Series
Lowrance	HDS-7/7M/7m Gen-2 Touch HDS-9m Gen2 Touch
Raymarine	ST70 Plus A57D A70/70D A60/65 e/c95/97
Seiwa	SW701x/cx
Simrad	NSS7
Standard Horizon	CP/F390i CPN700i
Techmarine	T50.05 - T55.05/7x TM5x



# W12

Housing to allow the easy installation of medium widescreen plotters up to 12" screen size.



**W12**  
Pod only



**W12-H**  
Helm mount



**W12-DB**  
White deck base



**W12-DB**  
Black deck base

## Product Order Codes

# Pod Dimensions

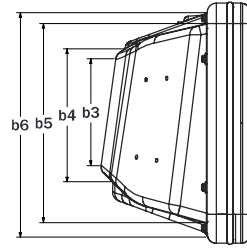
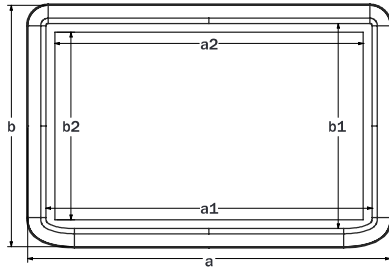

Pod Face Dimensions									
External Dimensions			Max Useable Face				Max Cut Out Area		
a	b	c	a1	b1	a2	b2			
392	261	164	354	222	338	205			
Pod Back Dimensions									
Width		Height				Depth			
a3	a5	b3	b4	b5	b6	c1	c2	c3	c4
152	337	116	144	216	244	47	55	78	147

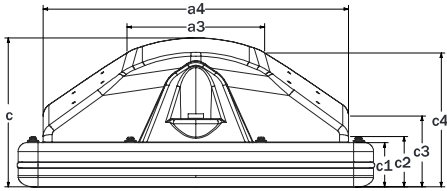

## As Installed Pod Dimensions

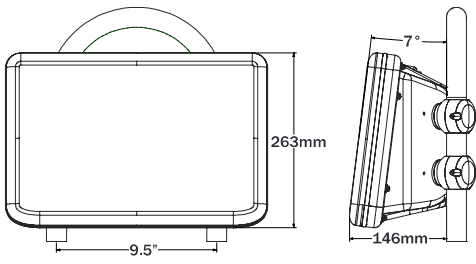

**9.5" Binnacle Rail**

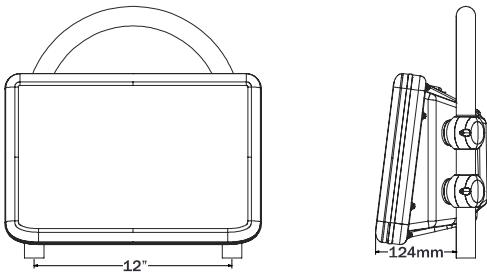

**12" Binnacle Rail**

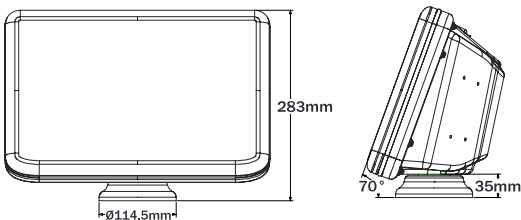

**Deck Mount**

## Pod Plotter Compatibility

Brand	Model Number
B&G	Zeus Z8/Touch 8 40/40HV
Furuno	MFD8
Garmin	GPSMAP4008 GPSMAP5008 GPSMAP6008 GPSMAP8008
Humminbird	ONIX 8 500/600 Series I 100 Series
Lowrance	HDS-8/8m
Raymarine	e/c 125/127 C80 E/C90 widescreen
Simrad	NSE8 NSS8
Standard Horizon	CPN1010i CPV350

